

NOTES: UNLESS OTHERWISE SPECIFIED

REVISIONS			
REV	DESCRIPTION	DATE	APPROVED

- BATTERY CONFORMS TO THE DESIGN REQUIREMENTS OF 14 CFR PART 25.1353(c).
- INSPECT PER FAR 21.303(h) QUALITY SYSTEM.
- SEE DRAWING NUMBER CB-00243 AND PROCEDURE P-1000 FOR ASSEMBLY AND TEST INSTRUCTION. PROCEDURE AND ASSEMBLY DRAWINGS ARE FOR INTERNAL USE ONLY
- TERMINAL HARDWARE KIT (CBC PN 9586) CONTAINS M8 HEX HEAD SCREWS, CONICAL WASHERS, AND INSTRUCTION TAG.
- BATTERIES ARE RATED IAW INTERNATIONAL ELECTROTECHNICAL COMMISSION STANDARD 952-1 UNLESS OTHERWISE SPECIFIED.

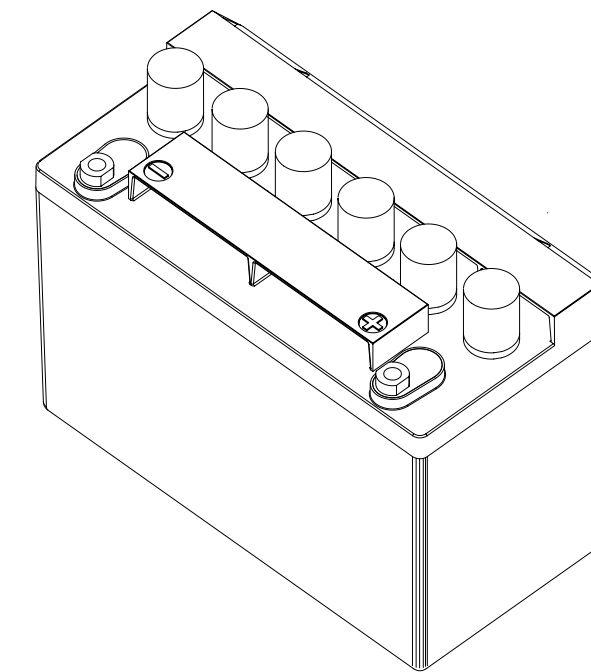

REFERENCE VIEW

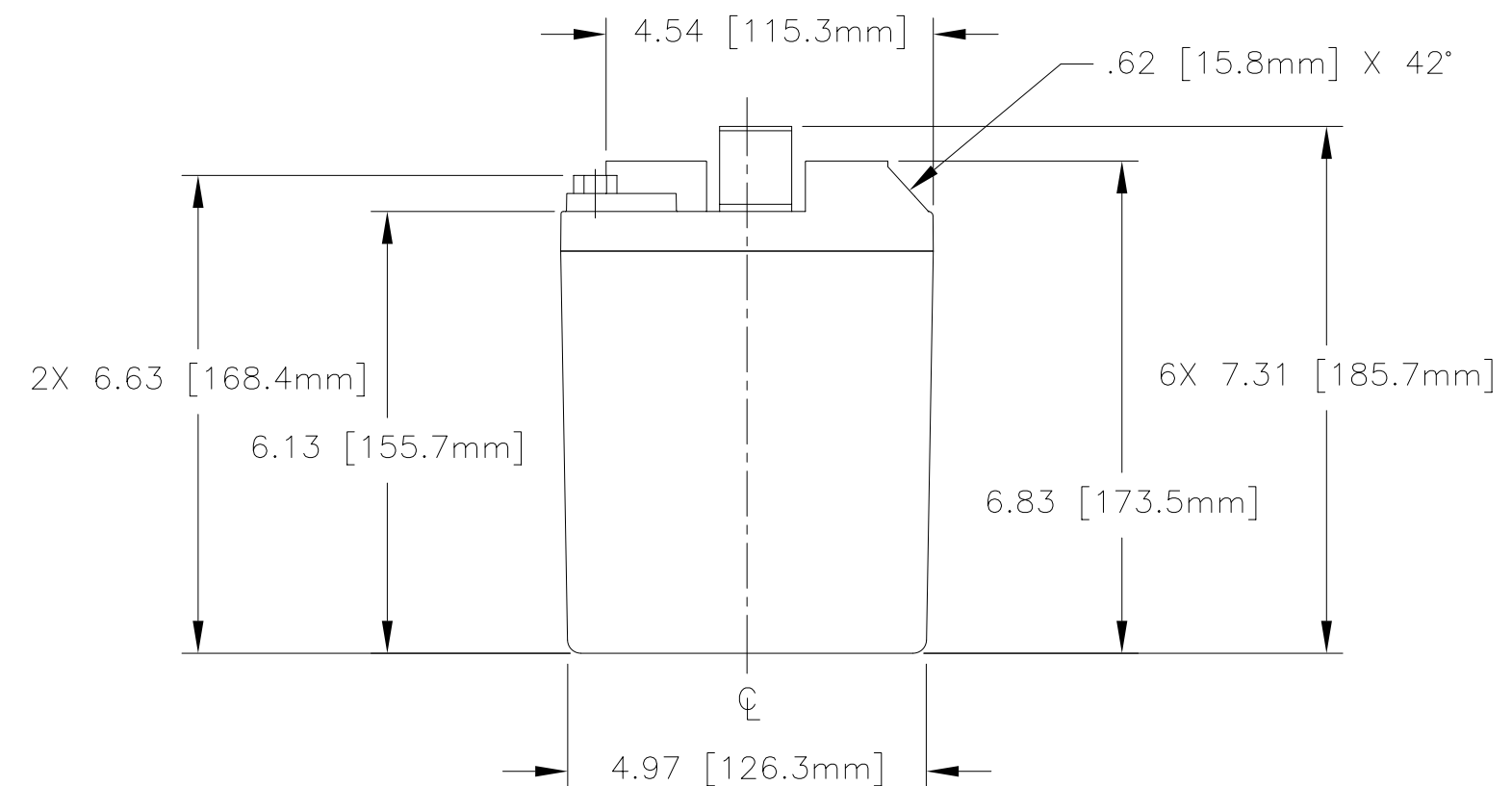
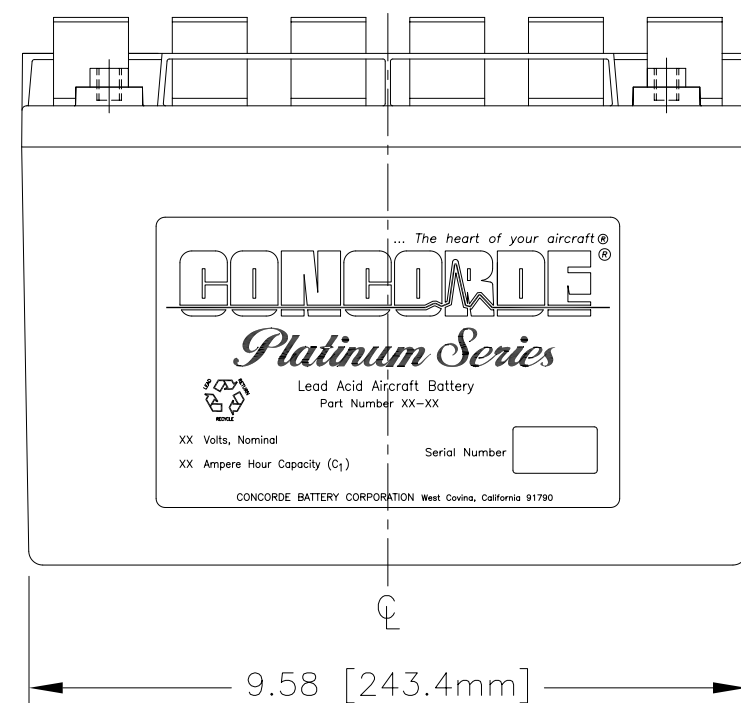
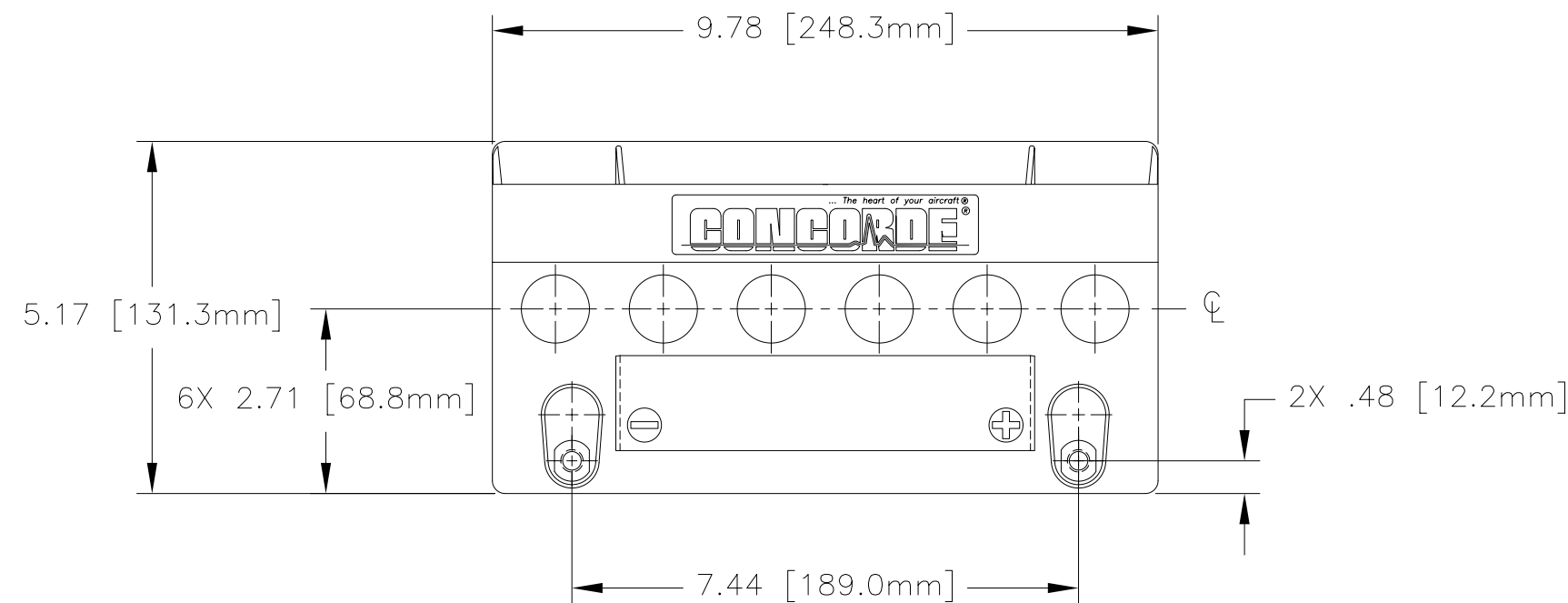

CAPACITY RATINGS	
PART NUMBER	CB-35AXC
MAXIMUM WEIGHT	32.5 LBS [14.8 KG]
RATED CAPACITY, C ₁	34 AH
POWER RATING AT 23°C (74°F)	lpr 939 A, lpp 1121 A
POWER RATING AT -18°C (0°F)	lpr 665 A, lpp 818 A
POWER RATING AT -30°C (-22°F)	lpr 492 A, lpp 613 A

ENVELOPE DRAWING

QTY REQD	CAGE CODE	PART OR IDENTIFYING NO.	NOMENCLATURE OR DESCRIPTION	MATERIAL SPECIFICATION	ITEM NO.
PARTS LIST					
UNLESS OTHERWISE SPECIFIED DIMENSIONS ARE IN INCHES TOLERANCES ARE: FRACTIONS DECIMALS ANGLES ± 1/32 .XX ± .06 ± 1° .XXX ± .060		CONTRACT NO.		CONCORDE BATTERY CORPORATION 2099 SAN BERNARDINO RD, W. COVINA, CA 91790	
TREATMENT NONE		APPROVALS		TITLE BATTERY, LEAD ACID, 12 VOLT, PLATINUM SERIES	
FINISH NONE		DRAWN S. VALDEZ		DATE 12/3/01	
SIMILAR TO		CHECKED HRF		DATE 12/3/01	
ACT WT		APPROVED JBT		DATE 1/15/02	
CALC WT		ISSUED AT		DATE 1/16/02	
SCALE 1=2.5			DWG NO. CB-35AXC		REV
SHEET 1 OF 1					

ENGINEERING COPY 16JAN02